

# STAINLESS STEEL NEEDLE VALVE BSP THREADED 8 - 50MM MODEL - SS2032

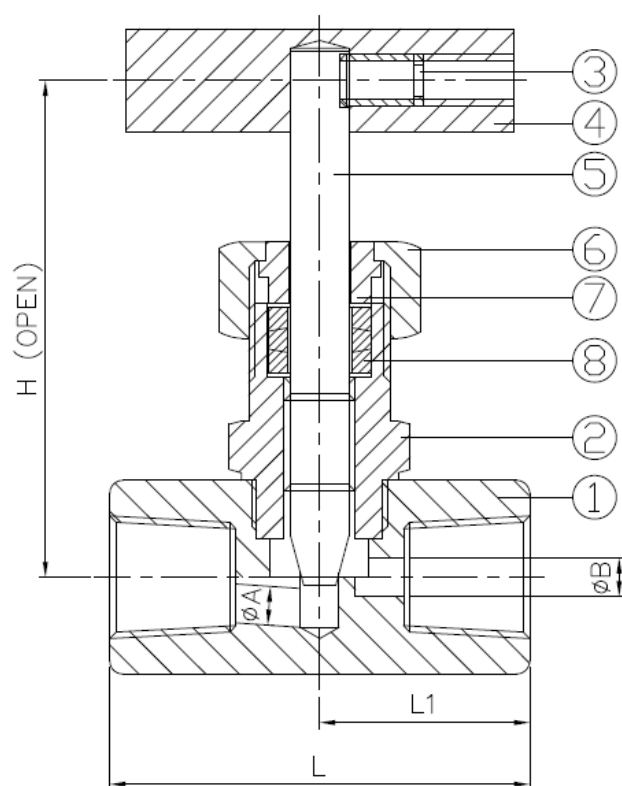

## FEATURES AND BENEFITS

- For Industrial, Chemical & General Applications
- 316 S/S Construction
- Threaded BSPT Ends
- Investment Cast Body
- Screwed-In Bonnet
- T Handle Operation
- Pressure Rating: 6000 PSI
- Working Temperature: -20°C~200°C
- Tested and Inspected to API598



NO.	PART NAME	MATERIAL
1	Body	ASTM A351-CF8M
2	Bonnet	ASTM A351-CF8M
3	Set Screw	SS 304
4	Handle	SS410
5	Stem	SS316
6	Gland Nut	SS304
7	Gland	SS304
8	Packing	PTFE

## APPLICATIONS

Challenger Valves and Actuators are the **“Right Choice for Valves and Actuation”** when quality matters.

Servicing industries such as : Water & Waste Water, Mining, De-salination, Pumping, Industrial Processing, Irrigation, Materials Handling and Chemical Services.

DIMENSIONS						
DN	A	B	H	L1	L	(Kg)
8	5	6	75	29	58	0.4
10	5	6	75	29	58	0.4
15	6	8	87	32.5	65	0.6
20	6	10	90	35	70	0.7
25	8	12	103	40	80	1.3
32	8	12	108	45	90	1.9
40	10	12	115	50	100	2.8
50	11	13.5	121	55	110	4