

CHALLENGER

DUCTILE IRON BUTTERFLY 16 BAR RATED U-DESIGN DOUBLE FLANGED WATERWORKS PATTERN

MODEL USSE

Features

- Size Range : 150 mm—350 mm
- 16 Bar Rated
- ISO5752 Face to Face
- ISO5211 Mounting
- Epoxy Coat RAL5015 @ 200 Microns
- EPDM Liner
- U Flanged Design as4087 Table C
- 150 mm -225 mm Lever Operated
- 250 mm -600 mm Gearbox Operator

OPTIONS

- BURIED SERVICE
- ELECTRIC ACTUATORS
- PNEUMATIC ACTUATORS
- EXTENSION SPINDLE



10 BAR RATED TORQUE Nm

NB Size	Wet Service
150	102
200	192
225	319
250	323
300	490
350	680

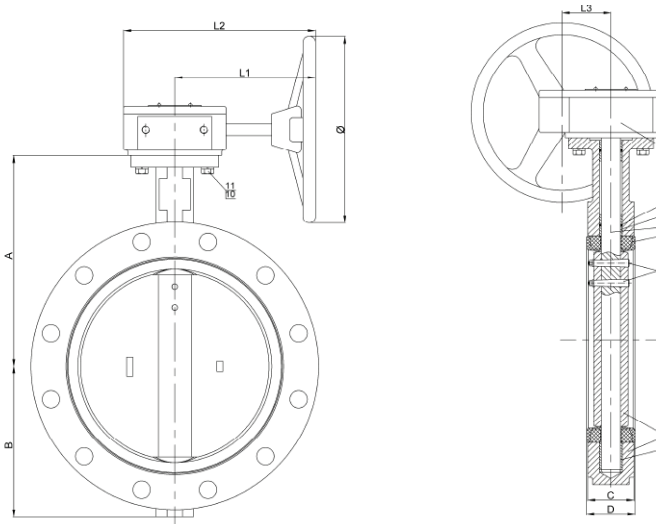

SIZE	C	D	A	B	L1	L2	L3	H/WHEEL
150 MM	54.5	59	226	133	121	226	45	150
200 MM	59.6	64.1	260	175	225	302	70	285
225 MM	67.5	68	292	203	225	302	70	285
250 MM	67	71.8	292	200	225	302	70	285
300 MM	75.5	79.5	337	242	225	307	85	285
350 MM	75.5	79.5	364	267	225	307	85	285

U Flanged Top Works

NB Size	ISO 5211 PCD	Shaft Dia
150	F07	17 x 17 Square
200	F10	17 x 17 Square
225	F10	22 x 22 Square
250	F10	22 x 22 Square
300	F10	22 x 22 Square
350	F10	31.70 mm x 8 mm Key

NO #	NAME	MATERIAL
1	BOLTS	SS 304
2	END COVER	GGG40 DUCTILE IRON
3	O-RING	EPDM
4	BUSHING	BRONZE
5	BODY	GGG40 DUCTILE IRON
6	DISC	CF8M STAINLESS STEEL
7	TAPER PIN	STAINLESS STEEL
8	SEAT	EPDM / NITRILE
9	SHAFT	416 SS
10	BUSHING	BRONZE
11	O-RING	EPDM
12	BOLTS	SS 304
13	GEARBOX	GGG40, SS INPUT SHAFT

CHALLENGER

DUCTILE IRON BUTTERFLY U-DESIGN DOUBLE FLANGED WATERWORKS PATTERN

MODEL USSE

Features

- Size Range : 375 mm—600 mm
- 16 Bar Rated
- ISO5752 Face to Face
- ISO5211 Mounting
- Epoxy Coat RAL5015 @ 200 Microns
- EPDM Liner
- U Flanged Design Table C
- 250 mm –600 mm Gearbox Operator

OPTIONS

- BURIED SERVICE
- ELECTRIC ACTUATORS
- PNEUMATIC ACTUATORS
- EXTENSION SPINDLE



10 BAR RATED TORQUE Nm

NB Size	Wet Service
375	830
400	846
450	1265
500	1634
600	2700

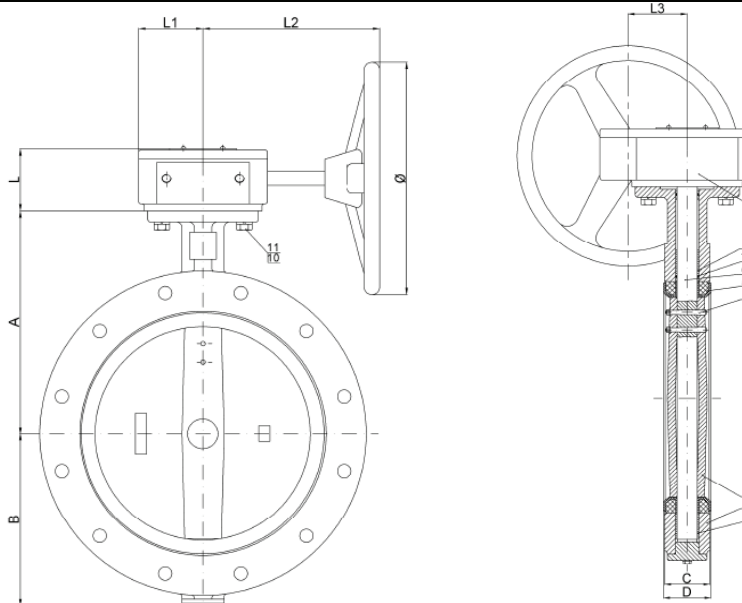

SIZE	C	D	A	B	L	L1	L2	L3	H/WHEEL
375 MM	102	106	375	313	118	130	292	120	285
400 MM	102	106	400	309	118	130	292	120	285
450 MM	114	119	422	337	118	130	292	120	285
500 MM	127	132	480	368	144	129	336.5	140	285
600 MM	151	156	562	459	144	129	336.5	140	285

Butterfly Top Works		
NB Size	ISO 5211 PCD	Shaft Dia
375	F14	31.70 mm x 10 mm Key
400	F14	33.10 mm x 10 mm Key
450	F14	38.00 mm x 10 mm Key
500	F14	41.10 mm x 10 mm Key
600	F16	50.60 mm x 16 mm Key

NO #	NAME	MATERIAL
1	BOLTS	SS 304
2	END COVER	GGG40 DUCTILE IRON
3	O-RING	EPDM
4	BUSHING	BRONZE
5	BODY	GGG40 DUCTILE IRON
6	DISC	CF8M STAINLESS STEEL
7	TAPER PIN	STAINLESS STEEL
8	SEAT	EPDM / NITRILE
9	SHAFT	416 SS
10	BUSHING	BRONZE
11	O-RING	EPDM
12	BOLTS	SS 304
13	GEARBOX	GGG40, SS INPUT SHAFT

CHALLENGER

**DUCTILE IRON BUTTERFLY
U-DESIGN DOUBLE FLANGED
WATERWORKS PATTERN
700 mm - 1000 mm**

MODEL USSE

Features

- Size Range : 700 mm—1000 mm
- 10 Bar Rated
- ISO5752 Face to Face
- ISO5211 Mounting
- Epoxy Coat RAL5015 @ 200 Microns
- EPDM Liner
- Flange Design AS4087 Table C
- Gearbox Operator

OPTIONS

- BURIED SERVICE
- ELECTRIC ACTUATORS
- PNEUMATIC ACTUATORS
- EXTENSION SPINDLE



10 BAR RATED TORQUE Nm

NB Size	Wet Service
700	3272
750	3767
800	4308
900	5257
1000	13389

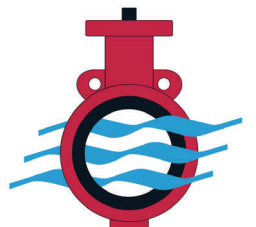

CHALLENGER
valves and actuators

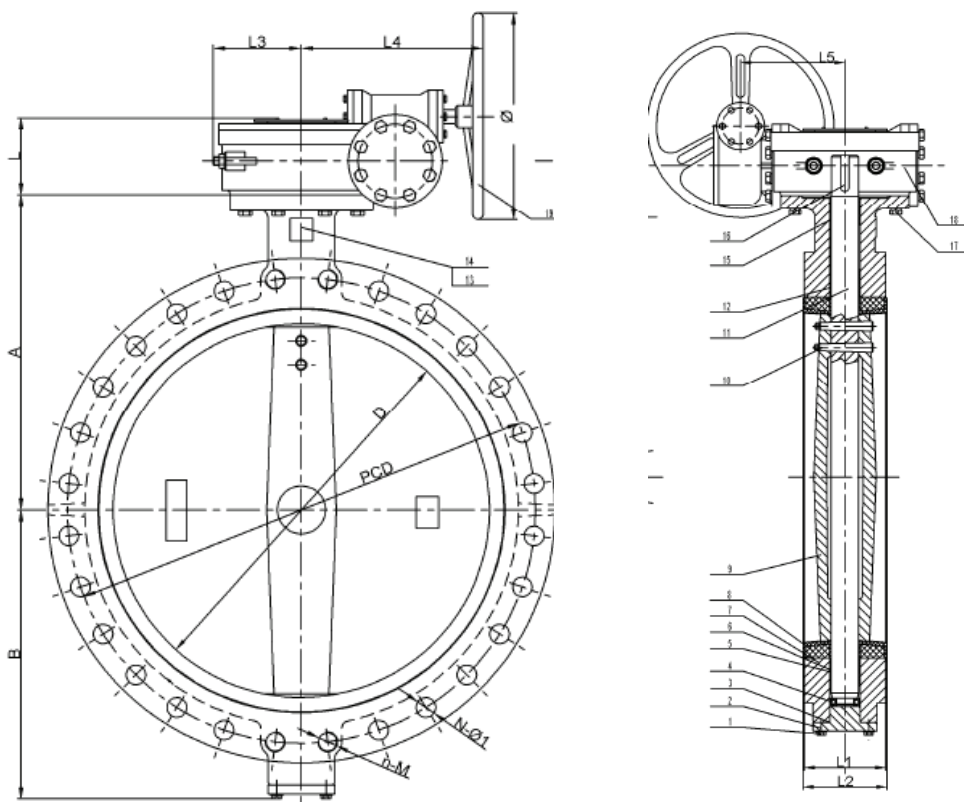

SIZE	L	L1	L2	L3	L4	L5	A	B	H/W	D	PCD	# HOLE x DIA
700 MM	165	165	169	172.50	362	242.5	626	527	425	694.2	845	20 x M27
750 MM	165	167	172	172.50	362	242.5	660	555	425	744.4	927	20 x M30
800 MM	165	190	195	172.50	362	242.5	666	605	425	794.8	984	20 x M30
900 MM	232	203	211	201	411	263.5	720	668	425	864.0	1092	24 x M33
1000 MM	232	216	224	201	411	263.5	806	728	425	964.2	1175	24 x M33

CHALLENGER**DUCTILE IRON BUTTERFLY
U-DESIGN DOUBLE FLANGED
WATERWORKS PATTERN****MODEL USSE****Options and Accessories for large diameter Butterfly Valves**

- Heavy Duty Pneumatic Scotch Yoke
- Electric Quarter Turn Actuator
- Spindle Extensions

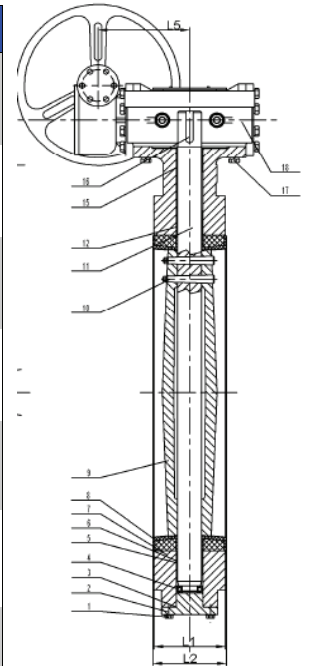

NO #	NAME	MATERIAL
1	BOLTS	SS 304
2	END COVER	GGG40 DUCTILE IRON
3	O-RING	NBR
4	THRUST BALL BEARING	STEEL
5	BODY	GGG40 DUCTILE IRON
6	O-RING	NBR
7	LONG BUSHING	BRONZE
8	SEAT	EPDM
9	DISC	CF8M STAINLESS STEEL
10	TAPER PIN	STAINLESS STEEL
11	SHAFT	431 SS
12	BUSHING	BRONZE
13	ID PLATE	ALUMINIUM
14	PLATE RIVETS	ALUMINIUM
15	BUSHING	BRONZE
16	KEY	STEEL
17	BOLTS	SS 304
18	GEARBOX	GGG40, SS INPUT SHAFT SS304 FASTENER
19	HANDWHEEL	GGG40 DUCTILE IRON

**U Flanged Butterfly Top Works**

NB Size	ISO 5211 PCD	Shaft Dia
700	F25	63.35 mm x 18 mm Key
750	F25	63.35 mm x 18 mm Key
800	F25	63.35 mm x 18 mm Key
900	F25	75.00 mm x 20 mm Key
1000	F25	85.00 mm x 22 mm Key



Valve Diameter	700 mm—1000 mm	
Pressure Rating	1000 kpa	
Test Pressure	Seat Test	1100 kpa
	Body Test	1500 kpa
Working Temperature	-15 + 150 degrees C	